Insured:
Property:

Cell:
Home:

Home: ~~1234 5678901234~~
Mountain Home, TX. 78058

Claim Rep.:

Business:

Estimator:
Business:

Business:

Reference:
Company:
Business:

Business:

Claim Number:

Policy Number:

Type of Loss: Hail

Date Contacted:	7/3/2023 11:17 AM	Date Received:	6/29/2023 1:00 AM
Date of Loss:	6/18/2023 12:00 AM	Date Entered:	7/3/2023 9:00 AM
Date Inspected:	7/6/2023 9:30 AM		
Date Est. Completed:	7/12/2023 5:14 PM		
Price List:	TXSA8X_JUL23		
Estimate:	Restoration/Service/Remodel		

**Residential
Dwelling (TWIA)
Roof**

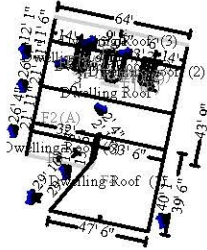

Dwelling Roof

5979.22 Surface Area
454.79 Total Perimeter Length

59.79 Number of Squares
107.75 Total Ridge Length

DESCRIPTION	QUANTITY	UNIT PRICE	TAX	RCV	DEPREC.	ACV
1. Remove Metal roofing - ribbed - 26 gauge - 1 1/8" to 1 1/2"	5,979.22 SF	0.53	0.00	3,168.99	(0.00)	3,168.99
2. R&R Drip edge	454.79 LF	3.15	35.61	1,468.20	(45.22)	1,422.98
3. R&R Valley metal	147.61 LF	6.83	25.21	1,033.39	(32.01)	1,001.38
4. Roofing felt - synthetic underlayment	59.79 SQ	48.24	88.79	2,973.06	(197.31)	2,775.75
5. Metal roofing - ribbed - 26 gauge - 1 1/8" to 1 1/2"	5,979.22 SF	7.21	1,130.07	44,240.25	(669.67)	43,570.58
6. R&R Flashing, 14" wide	65.50 LF	5.30	8.98	356.13	(11.40)	344.73
<i>Transition flashing from back slope to flat porch slopes</i>						
7. R&R Neoprene pipe jack flashing for metal roofing	3.00 EA	70.85	5.90	218.45	(3.50)	214.95
8. R&R Hip / Ridge cap - metal roofing	107.75 LF	9.76	21.09	1,072.74	(12.50)	1,060.24
9. R&R Chimney flashing - small (24" x 24")	2.00 EA	344.60	7.75	696.95	(9.84)	687.11
10. R&R Flue cap	2.00 EA	159.91	15.94	335.76	(39.37)	296.39
<i>Two chimneys</i>						
11. Remove Additional charge for steep roof - 7/12 to 9/12 slope	32.97 SQ	14.64	0.00	482.68	(0.00)	482.68
12. Additional charge for steep roof - 7/12 to 9/12 slope	32.97 SQ	46.21	0.00	1,523.54	(0.00)	1,523.54
Totals: Dwelling Roof			1,339.34	57,570.14	1,020.82	56,549.32
Total: Roof			1,339.34	57,570.14	1,020.82	56,549.32
Total: Dwelling (TWIA)			1,339.34	57,570.14	1,020.82	56,549.32

**Exterior (TWIA)
Exterior**

Front Elevation

DESCRIPTION	QUANTITY	UNIT PRICE	TAX	RCV	DEPREC.	ACV
-------------	----------	------------	-----	-----	---------	-----